



The

WONDER WEEKLY



Published by the Peter Underwood Centre

April 6, 2020

Architecture skills to draw upon: Page 2



Follow us on Facebook



www.facebook.com/UnderwoodCentre/

Take on our latest word puzzles: Page 2

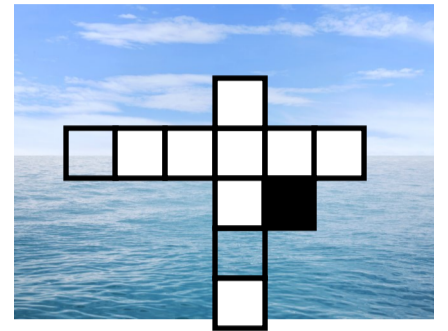

HANDY MASCOT

Professor to lead fun learning

MEET Professor Finn.

The team at the Peter Underwood Centre decided that the *The Wonder Weekly* needed a mascot to promote its fun learning activities.

And what better choice could there be than a red handfish?

After all, the Underwood Centre recently took responsibility for a real, live red handfish of its own through the Handfish Conservation Project.

More about that in weeks to come.

Red handfish are one of the rarest fish on the planet.

They are critically endangered and currently known to exist in just two locations in Tasmania — on two small patches of rocky reef near Hobart.

Researchers, including those at the University's Institute for Marine and Antarctic

Studies (IMAS), are working hard to prevent the species' extinction.

The red handfish is a very shy little creature, so there may be as yet undiscovered populations in south-eastern Tasmania.

Professor Finn was drawn for us by well-known Tasmanian cartoonist John "Polly" Farmer, who has done a fantastic job capturing one of the most unusual lifeforms in the marine world.

The Wonder Weekly will be revealing lots of facts and providing activities based around the red handfish in future editions, but if you have online access and can't wait until then, you can find out more at handfish.org.au/

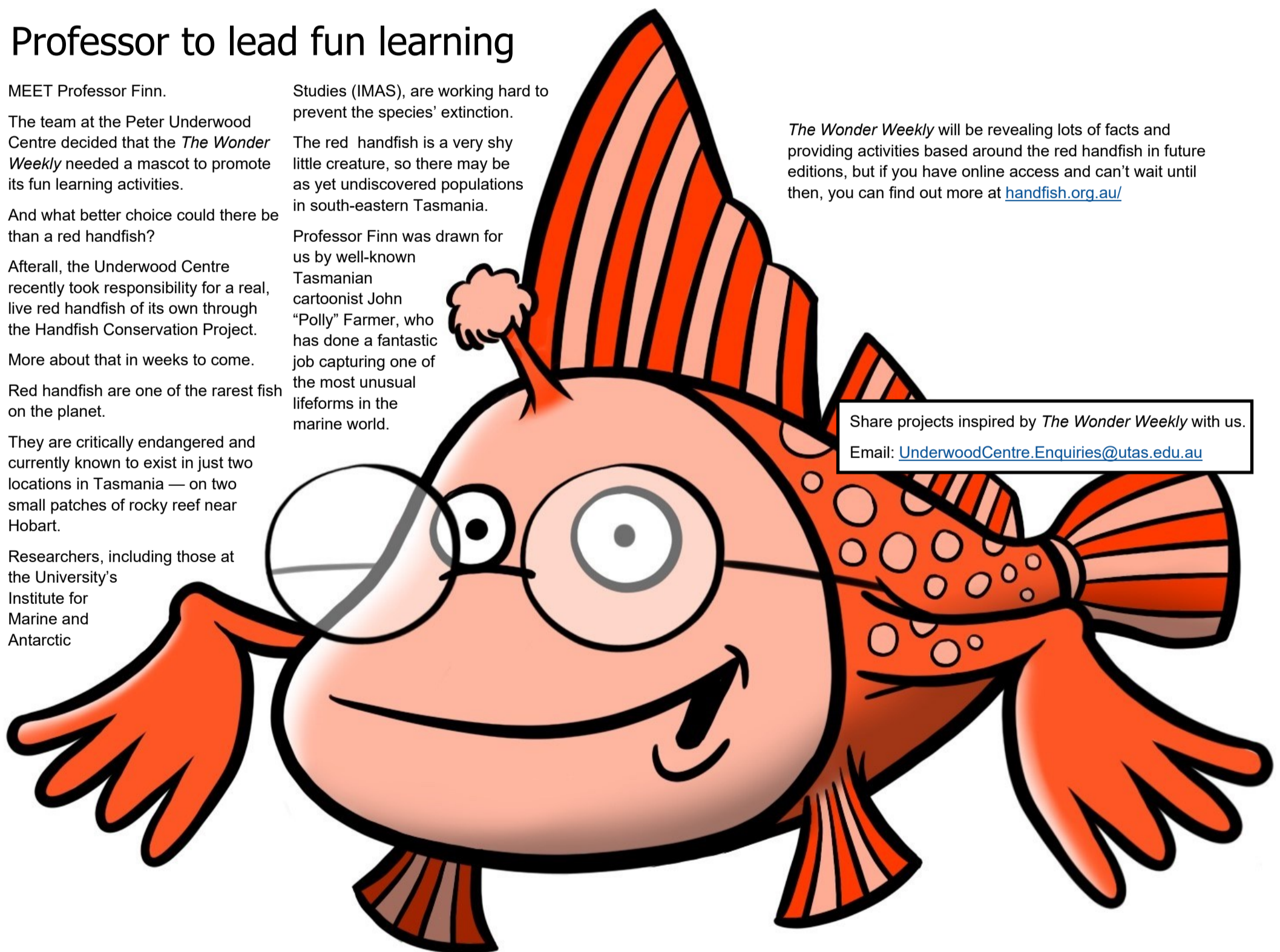

Share projects inspired by *The Wonder Weekly* with us.
Email: UnderwoodCentre.Enquiries@utas.edu.au

Bring golf to the fore by designing a backyard course of your own

YOU don't need clubs or even a golf ball to play backyard golf.

A tennis ball or a small ball of any kind and your imagination is all you require.

Golf courses are usually 18

holes, while some smaller courses are nine holes.

But your game can have as many holes as you like.

To create a hole you need a starting spot - which in golf is

called a tee - and a target, which in golf is marked by a flag.

Your target could be objects that you already have in your backyard.

Clothes lines or a fence posts

are good examples, or even a garden sprinkler.

An upturned bucket or pot make a great target to land the ball in.

The aim of the game is to hit the target or land the ball in the

bucket or pot with as few underarm throws or rolls as you can.

Remember to count your shots.

The more you practice the lower (better) your score will become.

"Education perhaps more than anything else is a passport to a better life." - Peter Underwood AC

Some architecture skills to draw upon



The forty-spotted pardalote.

HAVE you ever wondered what your home looks like from above?

Perhaps you have found where you live on www.google.com/earth/

Have you ever seen a site plan or a floor plan of a building?

Site plans provide a birds-eye view of a property, including its boundaries, buildings, trees, and hard surfaces like driveways and paths.

House floor plans can show walls, windows, doors and other fixtures like stoves, sinks, fireplaces, toilets, showers, even household furniture.

Your challenge is to draw a site plan of where you live and/ or a floor plan of your home.

If your house has two storeys you could draw one or both levels.

You will need to think about scale - a site plan could be 1:200 and a floor plan 1:100 (i.e. 1mm on the plan is equal to 100mm of the building).

It is a good idea to start with measuring the exteriors (boundaries of your land or outside walls of your house).

If you have a tape measure at home that will help, but you could just pace it out to get a rough idea.

You can try to be as accurate as possible, or just make your best guesstimate of distances.

Graph paper is useful if you have some, or just rule some straight lines on a normal piece of paper to guide you.

You will need a pencil and a ruler, and you can add some colour if you want to.

You could even draw things like trees and furniture, colour them in and place them on your plan (if you don't stick them down you can move them around).



Photo: iStock.com/Zinkevych



If you find you really enjoy drawing plans, you could draw other buildings, neighbourhoods, castles, playgrounds, anything that interests you; or perhaps designing interiors is more fun.

Many people use site plans and floor plans in their jobs — including architects, engineers and town planners.

Architecture and design can be studied at the University of Tasmania.

Children's University Tasmania members can earn stamps in your passports for this challenge, at the discretion of their school coordinator.

LANDSCAPE: Once you have a site plan sketch you can be creative.

Photo: iStock.com/Toa55

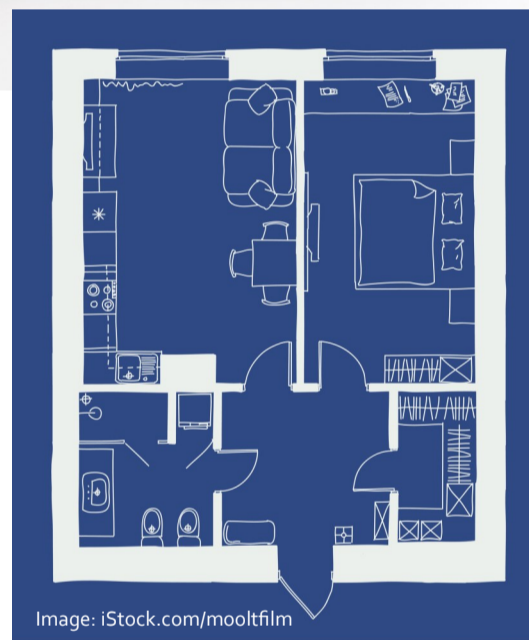

Image: iStock.com/mooltfilm

Have you accepted the birdwatching challenge?

CITIZEN scientists, we challenged you to keep an eye on the birds in your backyard in last week's edition.

Has anyone caught a rare glimpse of a forty-spotted pardalote?

Perhaps you have captured a photo of a bird in your yard.

Let us know how your birdwatching is progressing.

Email us:

UnderwoodCentre.Enquiries@utas.edu.au

Post: The Peter Underwood Centre
Private Bag 7
Hobart TAS 7001

Guess the country?

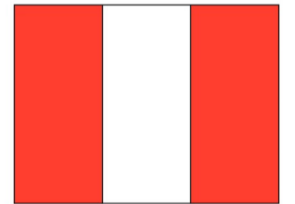

Image: iStock.com/Irina Kuznetsova

WORD SCRAMBLER

ANANAB _____ GARPFRTUTIE _____
AREP _____ DARINMAN _____
PLEPA _____ LUMP _____
TOOMAT _____
PERRYBARS _____



Crossword No.2 solution (check your answers)

Across
1. Duckling
4. Pigeon
7. Wattlebird
10. Eagle
11. Albatross
12. Ostrich
Down
2. Chicken
3. Feathers
5. Kiwi
6. Green
8. Eggs

Crossword No.3 - Bodies of water

Across

- 3. The Southern Ocean surrounds this continent
- 5. The world's largest ocean
- 7. Sea which separates south-east Australia and New Zealand
- 9. Spain, Italy and France all surround this sea
- 10. The Great Barrier Reef is in this sea
- 11. The world's longest river

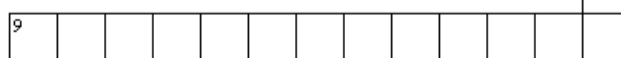

Down

- 1. Separates Tasmania from mainland Australia - Bass ...
- 2. City located on the banks of the Tamar River/kanamaluka
- 4. Explorer who named Botany Bay - James ...
- 6. Ocean to the west of Africa
- 8. Strahan is on the shore of this Harbour

For an additional challenge, try producing your own crossword.

Solution next week.