

Main Entrance from the corner of Church & Glover Streets.

If you are having issues with your access card, please email Sydney.Admin@utas.edu.au or call on (02) 8572 7999 for assistance.

ROZELLE CAMPUS ROOM CODES





- RZ.RZ01.L01.007 **Building 101** - eLab (Computer Lab)
- RZ.RZ01.L01.013 **Building 101** - Delta (Paramedic Prac Room)
- RZ.RZ01.L01.015 **Building 101** - Charlie (Paramedic Prac Room)
- RZ.RZ01.L01.019 **Building 101** - Bravo (Paramedic Prac Room)
- RZ.RZ01.L01.023 **Building 101** - Alpha (Paramedic Prac Room)

- RZ.RZ02.L01.002 **Building 103** - Seminar Room 2
- RZ.RZ02.L01.009 **Building 103** - Nursing Lab 2
- RZ.RZ02.L01.010 **Building 103** - Lecture Theatre (next to Student Kitchen)
- RZ.RZ02.L01.012 **Building 103** - Nursing Lab 1
- RZ.RZ02.L01.026 **Building 103** - Seminar Room 1

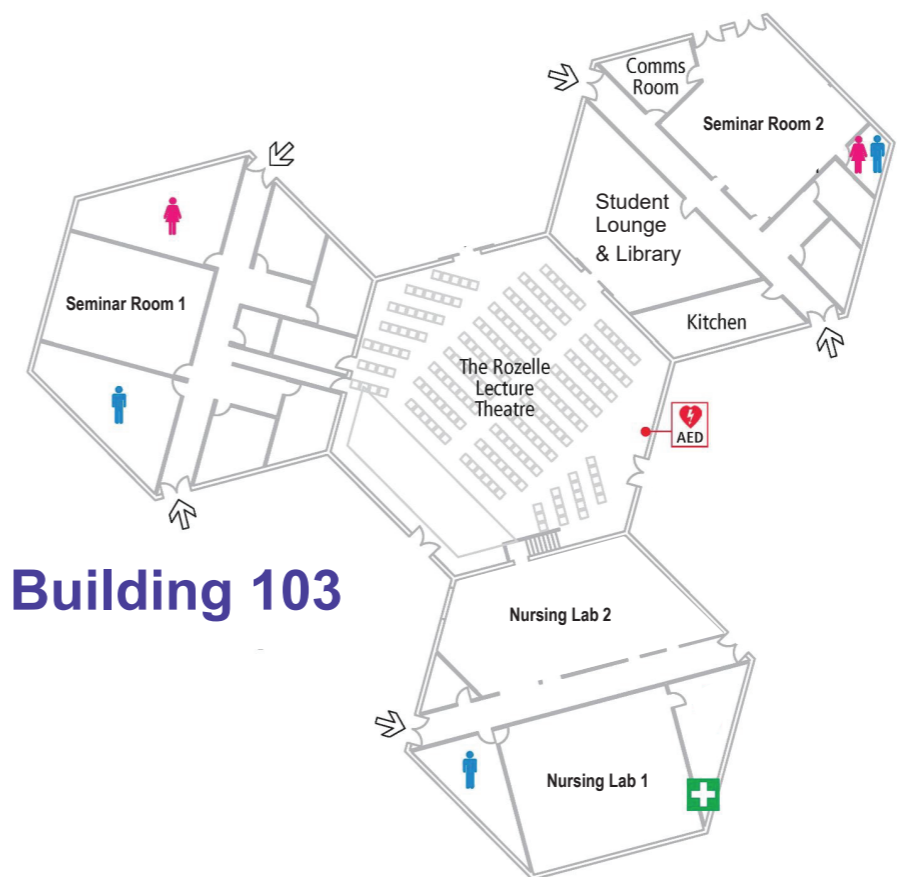
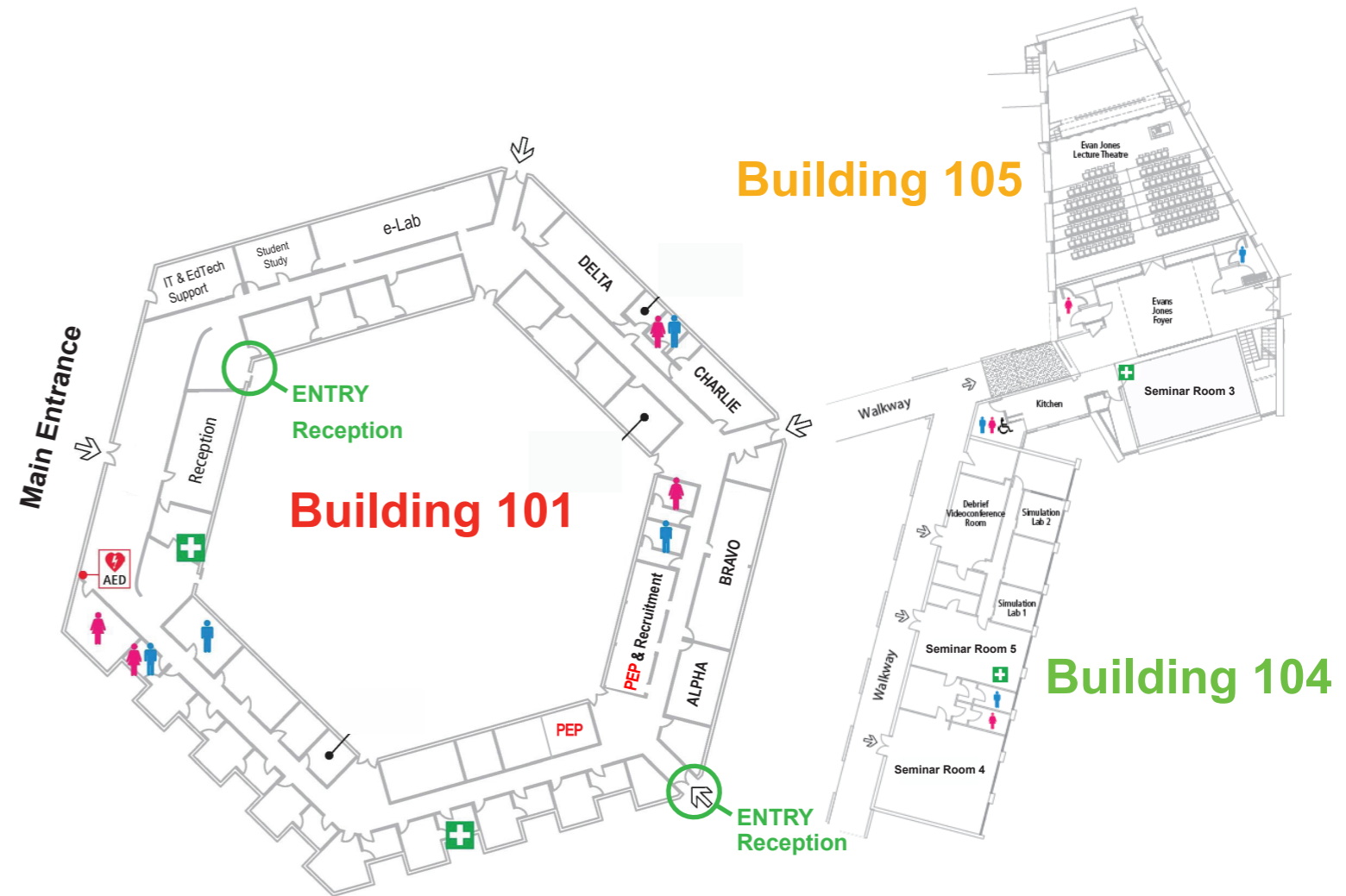
- RZ.RZ03.L01.100 **Building 104** - Seminar Room 4
- RZ.RZ03.L01.105 **Building 104** - VC Room (RZ.105 Simulation Debrief Room)
- RZ.RZ03.L01.102 **Building 104** - Seminar Room 5

- RZ.RZ05.L01.115 **Building 105** - Evan Jones Lecture Theatre
- RZ.RZ05.L01.117 **Building 105** - Seminar Room 3 (Squash Court)



-  Toilet
-  Entrance
-  First Aid
-  Automated External Defibrillator

